

Mobile phone transceiver

BE1433



Connects Visit to your mobile phone, tablet or smartwatch.

The Mobile phone transceiver makes it easier than ever to keep tabs on your home. It connects the Visit system to your mobile phone, tablet, or smartwatch via Bluetooth. Once you have installed the Visit app, you will start to receive Visit notifications on your mobile device. In addition, your Visit receiver will alert you to incoming calls and messages on your mobile device.

It complements your existing receiver by providing additional information on your alerts, allowing you to customize your notifications, browse the notifications history and get an overview of your connected devices.

The Mobile phone transceiver can also alert to your landline telephone and has a trigger port that can be used for a contact mat, doorbell, or magnetic switch accessory.



Features

Bluetooth powered

Up to 250 m coverage, open field

App controlled

Available for iOS & Android

Sends Visit alerts to mobile devices

Displays Visit alerts on your phone, tablet or smartwatch

Alerts for mobile calls and messages

Signals your Visit receiver when you get incoming calls or messages



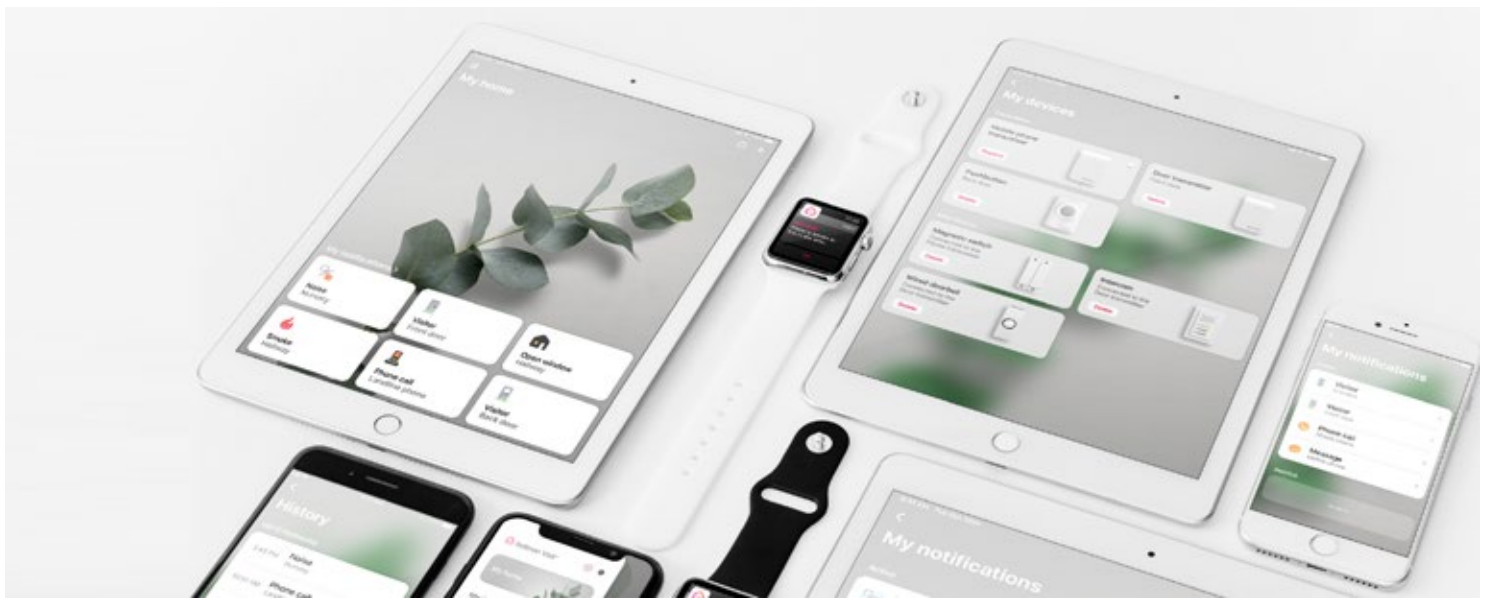

Size and weight

- Height: **100 mm, 4.0"**
 Width: **65 mm, 2.6"**
 Depth: **27 mm, 1.1"**
 Weight: **120 g, 4.2 oz. incl. batteries**



Buttons and connectors

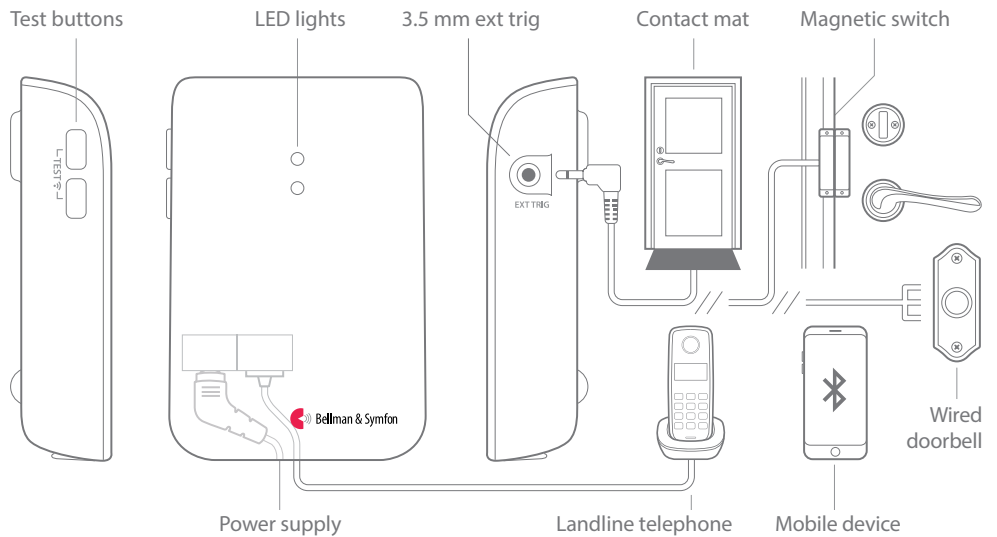

Connectivity

- RJ11 input to analogue telephone network
- 3.5 mm ext. trig port for accessories
- Power supply jack
- Bluetooth 5.0

Activation

- A mobile device via Bluetooth
- The test buttons and the landline telephone
- The contact mat or magnetic switch accessory
- A wired doorbell connected to the ext. trig. port

Compatibility

- iOS11 and later | Android 6 and later
- iPhone 6S and later | Modern Android devices

Environmental requirements

- For indoor use only.
- Temperature: 0° to 35° C, 32° to 95° F
- Relative humidity: 15% – 90% (non condensing)

Power and battery

- Mains power: 5 V DC / 1000 mA
- Backup batteries: 2 x 1.5 V AA Alkaline

Frequency and coverage

- ISM frequency: 868.30 MHz
- ISM coverage: Up to 250 m (275 yd)
- Bluetooth frequency: 2400 – 2483.5 MHz
- Bluetooth coverage: Up to 250 m

Number of radio keys

- 64 as standard.

Maintenance and cleaning

- Use a soft, lint-free cloth. Avoid getting moisture in openings. Don't use household cleaners.
- Not reusable.

In the box

- BE1433 Mobile phone transceiver
- Power adapter and power cable
- Pre-mounted telephone cable
- 2 x 1.5V AA alkaline batteries
- Telephone splitter
- Screw and plug



Accessories

The following accessories are available:

- BE9023 Magnetic switch
- BE9026 Contact mat
- BE9253 External trigger cable (3.5 mm connector)

© 2021 Bellman & Symfon AB. All rights reserved

Bellman, Bellman & Symfon and the Bellman & Symfon logo are registered trademarks of Bellman & Symfon AB. This leaflet is subject to change without prior notice.